

## Delta T Stage Adapters and Accessories

### Controller and Dish Accessories

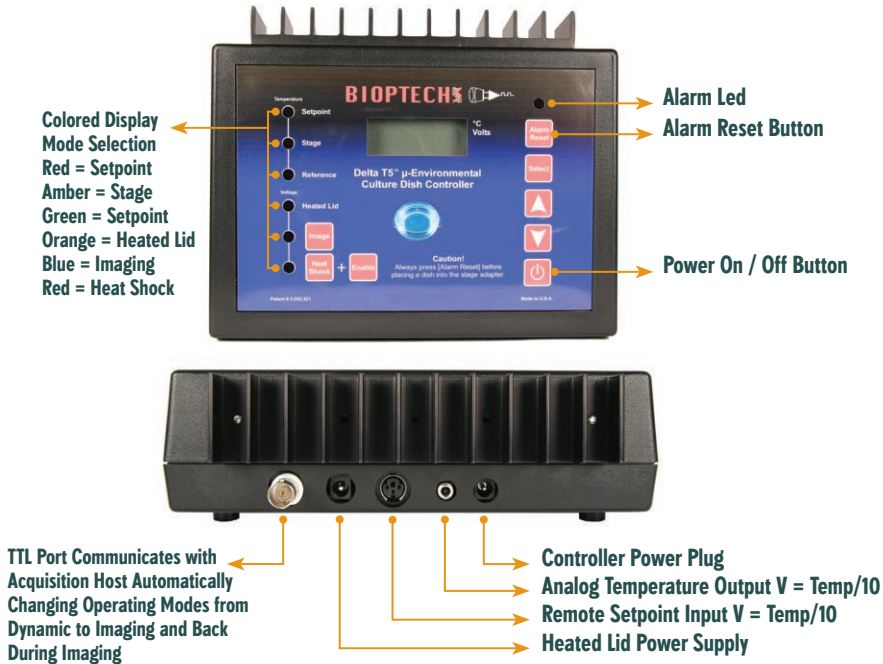

### Hinged Perfusion Adapter

The Bioptechs Hinged Perfusion Adapter provides Delta T users with a convenient and inexpensive method of supporting perfusion needles in the culture dish. The typical application is to maintain low-volume perfusion over cells during long term-experiments. Perfusion adapters are sold in pairs. One hinge and needle is a supply, the other is a drain. The balance between supply and drain can be maintained continuously with the use of the Micro Perfusion Pump. Additional supports can be added to hold gas jets, pH probes, cooling apparatus, or other items which do not require critical positioning.

### Hinged Perfusion Adapter



### Coverglass Lid

The Coverglass Lid is a cover for the Delta T Culture Dish to be used when imaging to create an optical surface onto the liquid in the dish. This eliminates the optical effect of fluid motion at the air to liquid surface above the cells that causes the contrast of the image to change. Therefore, when acquiring a series of images in a transmitted light, contrast enhancing mode of microscopy, all images will have a uniform contrast.

Forming an optically flattened glass to media surface on the top of the cells eliminates this problem. The Coverglass Lid fits loosely on the Delta T Culture Dish and supports a 1 mm x 22 mm coverglass in the center of the field 3mm above the specimen. The Coverglass Lid is reusable and helps the Delta T bridge the gap between an open dish and a closed

### Perfusable

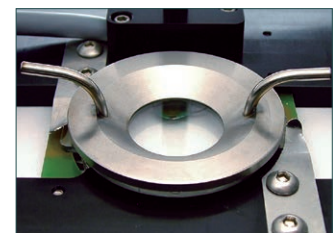

### Non-perfusable

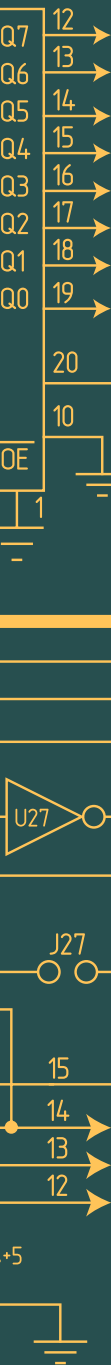
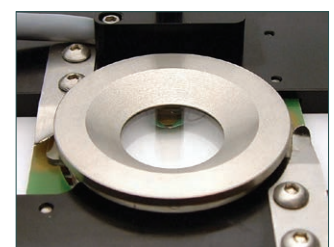

**Heated Lid****Heated Lid**

The Biopetechs Delta T Heated Lid is a device which will provide a condensate free optical surface on the top of a Delta T Dish through which specimens can be perfused and trans-illuminated on an inverted microscope. It is reusable and powered by a 2.5 volt source from either a battery or the optional auxiliary power supply in the Delta T Controller. A CO<sub>2</sub> port is included.

The Biopetechs Delta T Heated Lid w/ Perfusion is a device which will provide a condensate free optical surface on the top of a Delta T Dish through which specimens can be perfused and trans-illuminated on an inverted microscope. Specimens can be perfused by attaching perfusion tubing to the ports provided. It is recommended to use the Biopetechs Micro-Perfusion Pump with the dual perfusion tubing for this purpose.

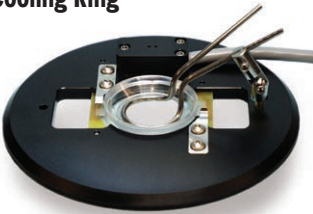
**Cooling Ring****Delta T Cooling Ring**

The Biopetechs Cooling Ring is an immersion device which absorbs heat from the specimen by providing a thermally conductive physical barrier between chilled fluid passing through the ring and the fluid surrounding the specimen. This cooling ring is made of autoclaveable 304 stainless steel and provides the microscopist with a convenient and inexpensive method of reducing the temperature of specimens in Delta T culture dishes. The cooling ring is supported on the stage adapter and translates along with the dish. It is easily flipped out of the way to enable easy exchange of dishes in the stage adapter

**Brain Slice Adapter****Brain Slice Adapter**

The Biopetechs Brain Slice Adapter is combined with the Delta T® Culture Dish System to provide a convenient method of observing thick cut sections of brain or other tissue in a perfusable, temperature controlled, optical environment on an inverted microscope. Perfusion ports are made of 304 stainless steel and are compatible with 1/16" tubing. As with all Biopetechs Delta T® Culture Dish Adapters, the specimen is adjustable in the Z axis plane to accommodate the working distance of the objective. Custom geometry adapters are available upon special order to accommodate specimens having unique geometry.

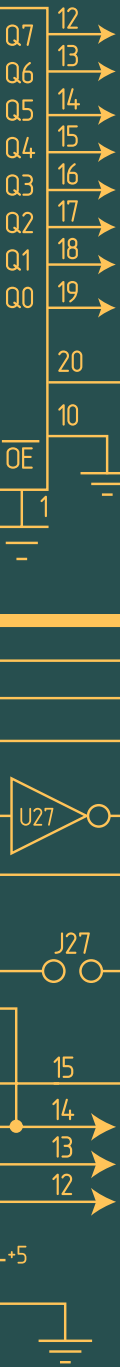

**Biotechs Delta T Stage Adapters**

The Biotechs Delta T Stage adapter reads the temperature of the Delta T Dishes, provides electrical contacts to power the dishes and supports the dish on the stage for translation. All Delta T systems require a Stage Adapter. These pictures are provided to assist in selecting a stage adapter appropriate for your microscope.

**Stage Adapters**

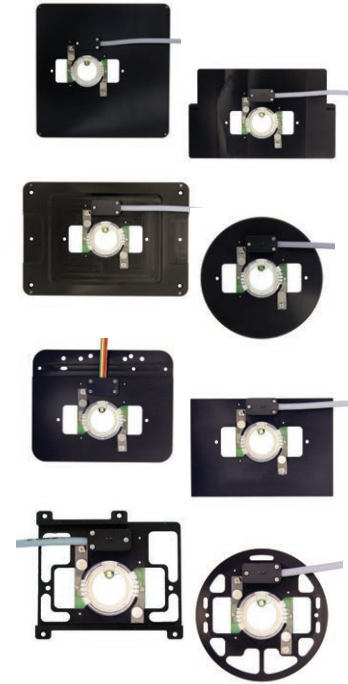

**Ordering Information**

Part No.	Delta T
Bi-0420-4-Start	<b>Delta T Starter Kit - Heated Dish Stage</b> Incl: Delta T Controller, 10pk of Delta T Dishes, Coverglass Lid, Heated Lid with CO <sub>2</sub> port, Culture Cylinder Pack and Standard Stage Adapter
Bi-0420-4-03	<b>Delta T4 Culture Dish Controller</b>
Bi-04202003	<b>Delta T Culture Dish Stage Adapters 96-Well Plate Sized</b>
Bi-0420042105C	<b>Delta T Culture Dishes (10/pk) 0.5mm thick glass (clear)</b>
Bi-0420040500	<b>Delta TPG Uncoated (no temperature control) Culture Dishes (10/pk) 0.5mm thick glass</b>
Bi-0420201918	<b>Delta T Tissue Slice Adapter</b>
Bi-0420201919	<b>Delta T Brain Slice Adapter</b>
Bi-0420081601	<b>Delta T Hinged Perfusion Adapter Set (2/set)</b>
Bi-04200318	<b>Delta T Cooling Ring</b>
Bi-0420080316	<b>Delta T Perfusable Heated Lid</b>
Bi-070303-1919	<b>Glass Culture Cylinder Starter Set (2, 4, 6, 8, 10 mm i.d x 5mm high)</b>
Bi-070303-01	<b>Glass Culture Cylinders</b> -several sizes available
Bi-260700	<b>Boekel Warmer</b>
	Complete Biotechs product line available.

U.S./Canada prices shown. International prices add 15%. Email or visit web store for latest prices.

